

SOLAR FLOOD LIGHT 300W

LD- **300 W**

Application Place :

It is widely used in home lighting, streets and roads, residential areas, scenic spots, parks, squares, private gardens and other public places, also used for night lighting of advertising board, and construction outdoor lighting, easy to install, energy saving, no need to pay electric fee, longer life span.

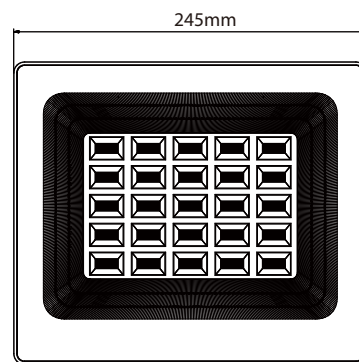
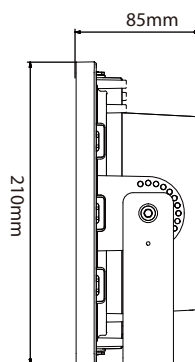

Product Parameters

| | |
|-----------------------|--|
| Light brightness | 3000 Lumens (equal to 300W incandescent lamp) |
| Solar Panel | 5V 50W polysilicone, 25 years lifetime; |
| Battery | 3.7V 46000mAh LiFePO 4 Battery, 12 years life time |
| Light Source | 180lm/W - LED 5050 4000K (Yellow) |
| Charging Time | 4-6 hours |
| Lighting Time | All night lighting, with remote controller |
| Solar Panel Dimension | 535*515*25mm |
| Cable Length | 2.4 meters with golden connector |
| Lamp Viewing Angle | 90° |
| Warranty | more than 5 years |

Product Display

- ON key: turn on
- OFF key: turn off
- AUTO key: Reset, 6+X overnight lighting mode
- 6H key: lights off after 6 hours
- 8H key: lights off after 8 hours
- 85% key: reduce 15% power
- 70% key: reduce 30% power



Solar Panel + Bracket



Lamp Holder



Remote Control



M6 Hex Key



Packaging Display



M6×20Hexagon socket bolt

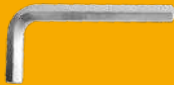

M5 Hex Key



M6 Flat gasket



M6 Nut

SOLAR FLOOD LIGHT

Product Advantage

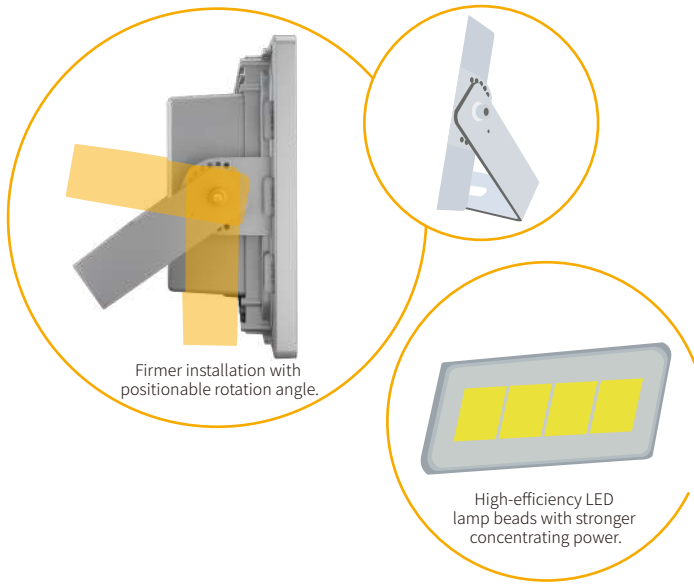

- Independent R&D, patented products, integrated design, modular production, one-click installation.
- Powered by Cree LED™ Products, with 100000 hrs life span.
- With LiFePO4 battery, high safety, long life span.
- Diamond surface reflection process, reflecting light source, enhancing the brightness of the lighting effectively.
- Widened and thickened bracket, positionable angle, installation stable & firm.
- With PC outdoor optical lens. High light transmittance, high temperature resistance and aging resistance.
- Gold-plated aviation plug, higher transmission speed, more safer.
- Low voltage design, safe and reliable.
- Integrated package, convenient transportation.

- 1 PC outdoor optical lens
- 2 Diamond surface reflection technology
- 3 Waterproof ring
- 4 High efficiency LED
- 5 Control & drive integrated lamp board
- 6 LiFePO4 battery
- 7 Built in military plug
- 8 High density aluminum magnesium alloy die casting
- 9 Bracket

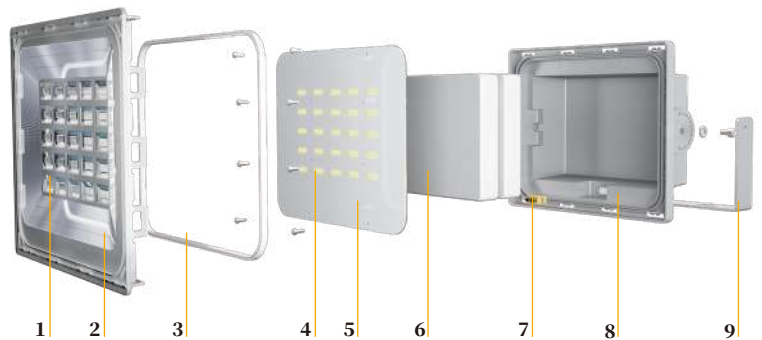

Installation Cases and Applicable Scenarios

